

# Knox County Regional Airport Layout Plan

AIP No. 3-23-0041-01

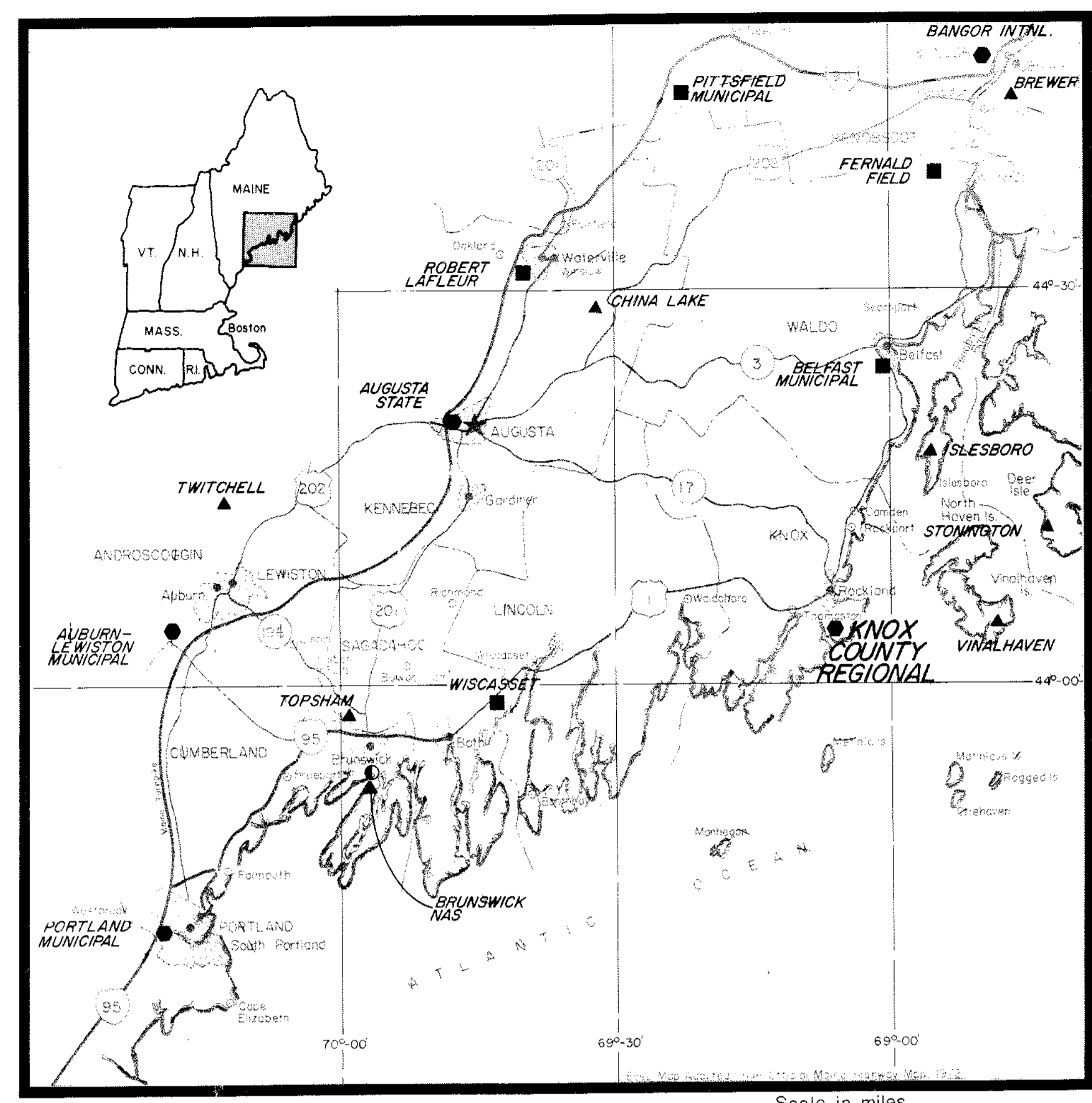

Vicinity Map

Knox County Regional Airport — Owl's Head, Maine

## Index of Sheets

Title Sheet	1
Existing Airport Facilities	2
Airport Layout Plan	3
Terminal Area Plan	4
Runway and Approach Slope/ Plans and Profiles	5
FAR Part 77 Surfaces	6
Land Use Plan and Noise Exposure Contours (Ldn)	7

Approved \_\_\_\_\_ Director  
Maine DOT, Division of Aeronautics

Date \_\_\_\_\_

Approved \_\_\_\_\_ Chairman  
Knox County Commissioners

Date \_\_\_\_\_

## Revisions

Date	By	Remarks

Prepared by:

**Edwards and Kelcey, Inc.**

Date September 30, 1984

Knox County Airport  
 Approved ALF

FEB 5 1985

FAA APPROVED  
DATE MAR 11 1985

	RUNWAY 3-21		RUNWAY 13-31	
	EXISTING	ULTIMATE	EXISTING	ULTIMATE
Effective Gradient (%)	0.13	SAME	0.24	SAME
% Wind Cover (12 MPH)	94.2	SAME	93.9	SAME
Pavement Strength	NON-PREC	SAME	VISUAL	SAME
Runway Classification	S: 20,000 R: 44,000	SAME	S: 30,000 R: 44,000	SAME
Approach Slope (Part 77 TERPS)	R/W 3: 34.1/20.1 R/W 21: 20.1	SAME	20:1	SAME
Runway Lighting	MIRL	MIRL	MIRL	SAME
Runway Marking	NON-PREC	SAME	BASIC	SAME
NavAids	LOC, MALSF	LOC/OME, MALSF	NONE	SAME
Visual Aids	VASI, REILS	SAME	REILS/R/W 31	VASI, REILS

AIRPORT DATA		
	EXISTING	ULTIMATE
Airport Elevation (MSL)	55.8'	61.5'
Airport Reference Point (ARP)	44° 04' N 69° 06' W	-
Mean Max. Temp. (Hottest Month)	76°F	78°F
Taxiway Lighting	MITLS	MITLS
Airport Classification	TRANSPORT	TRANSPORT
Airport Property (Acres)	351	354

BUILDING DATA		
NO.	STRUCTURE(S)	ELEV.
1	Pilots Lounge/Terminal Building	69
2	FBO (Downeast) Lease Area - Hangar	89
3	T-Hangar (6 Bay)	70
4	Airport Manager House	81
5	Storage Building	70
6	Airport Maintenance Building	72
7	Non-Aviation (USGS) Building (Storage)	75
8	Non-Aviation Use Buildings (Storage)	82
9	FBO Area (Stonington Flying)	80

LEGEND	
	EXISTING
Town Line	---
Property Line	=====
Restriction Lines	----
Apron, T/W, R/W	----
Buildings	□
Fence	----
Runway Lights	•
Approach Lights	□
Fuel Farm	⊕
Contours	~
Clear Zone	----
Tree Line	~
Utility Poles	⊕
Ledge Area	XXXX

Revisions	
Remarks	Date

# Knox County Regional Airport MASTER PLAN

## Existing Airport Facilities

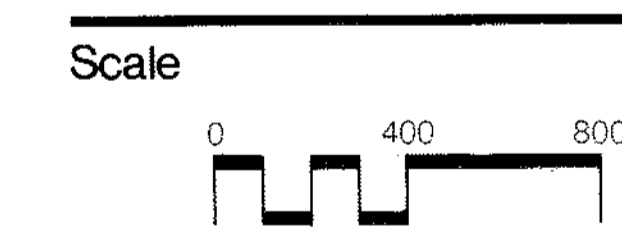

Prepared by  
**Edwards and Kelcey, Inc.**

Date  
September 30, 1984

Approved by

Planner

FEB 5 1985

M T  
MAG DEC 18° 30'

Dwg. No.  
**2**

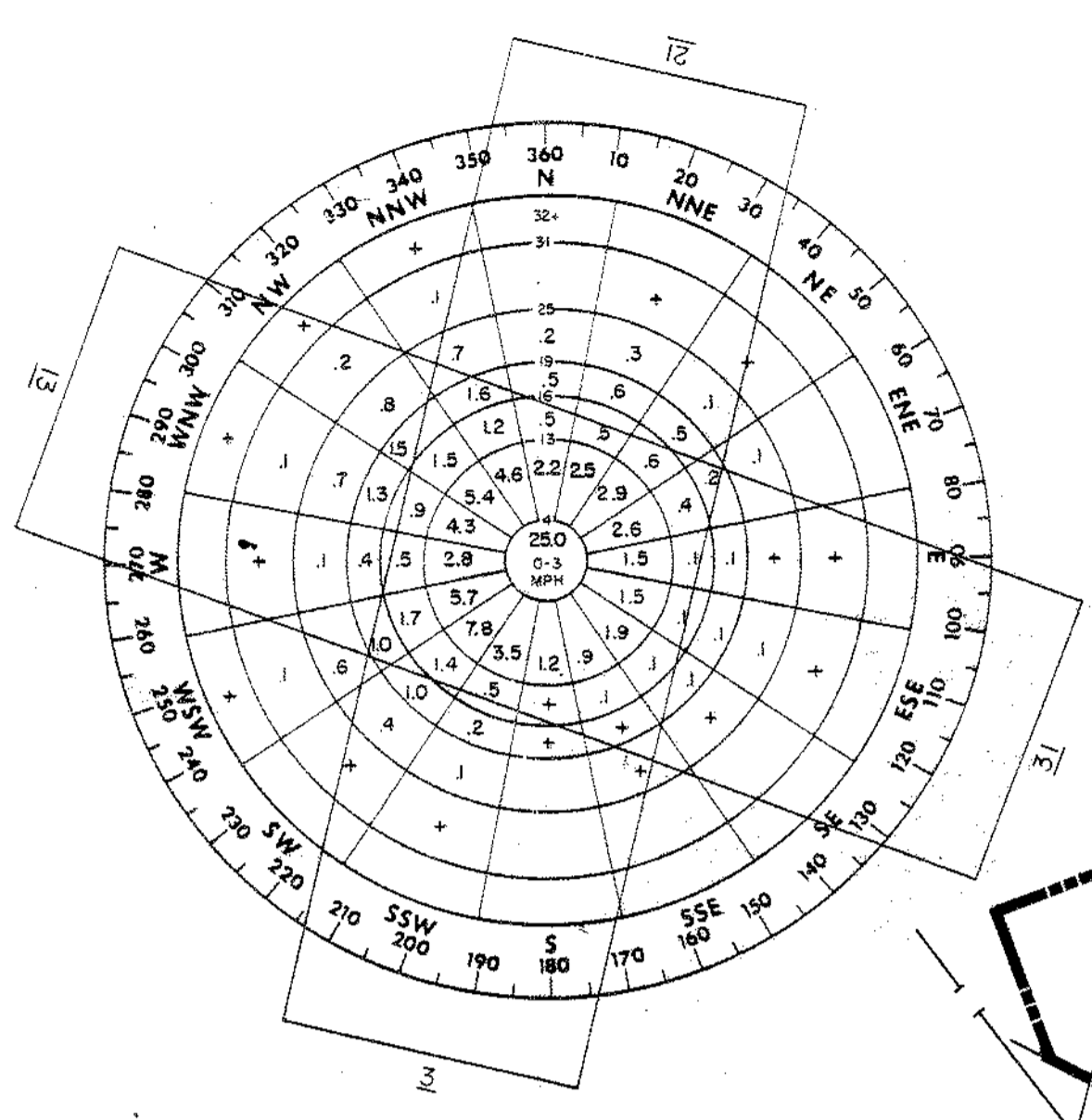

VFR WIND ROSE  
CEILING > 1500 FT.  
VISIBILITY > 3 MILES

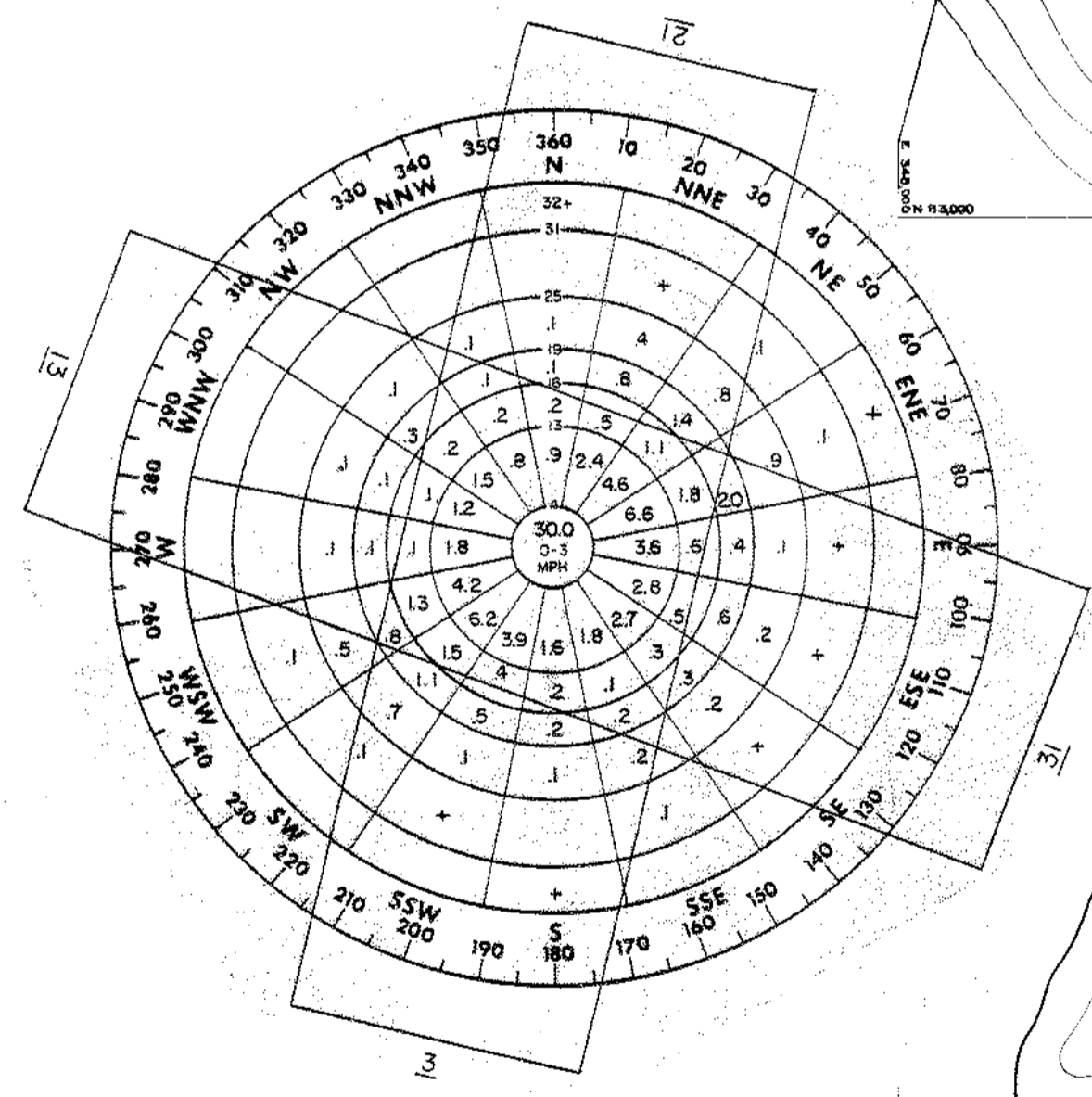

IFR WIND ROSE  
200 FT. ≤ CEILING ≤ 1500 FT.  
1/4 MILE ≤ VISIBILITY ≤ 3 MILES

RUNWAY WIND COVERAGE		
	% VFR	% IFR
RUNWAY 3-21	93.90	95.05
RUNWAY 13-31	94.25	92.40
BOTH RUNWAYS		

SOURCE: NATIONAL CLIMATIC DATA CENTER  
6/54 - 5/59 (8-13 OBS./DAY)  
NO OBSERVATIONS = 20,991

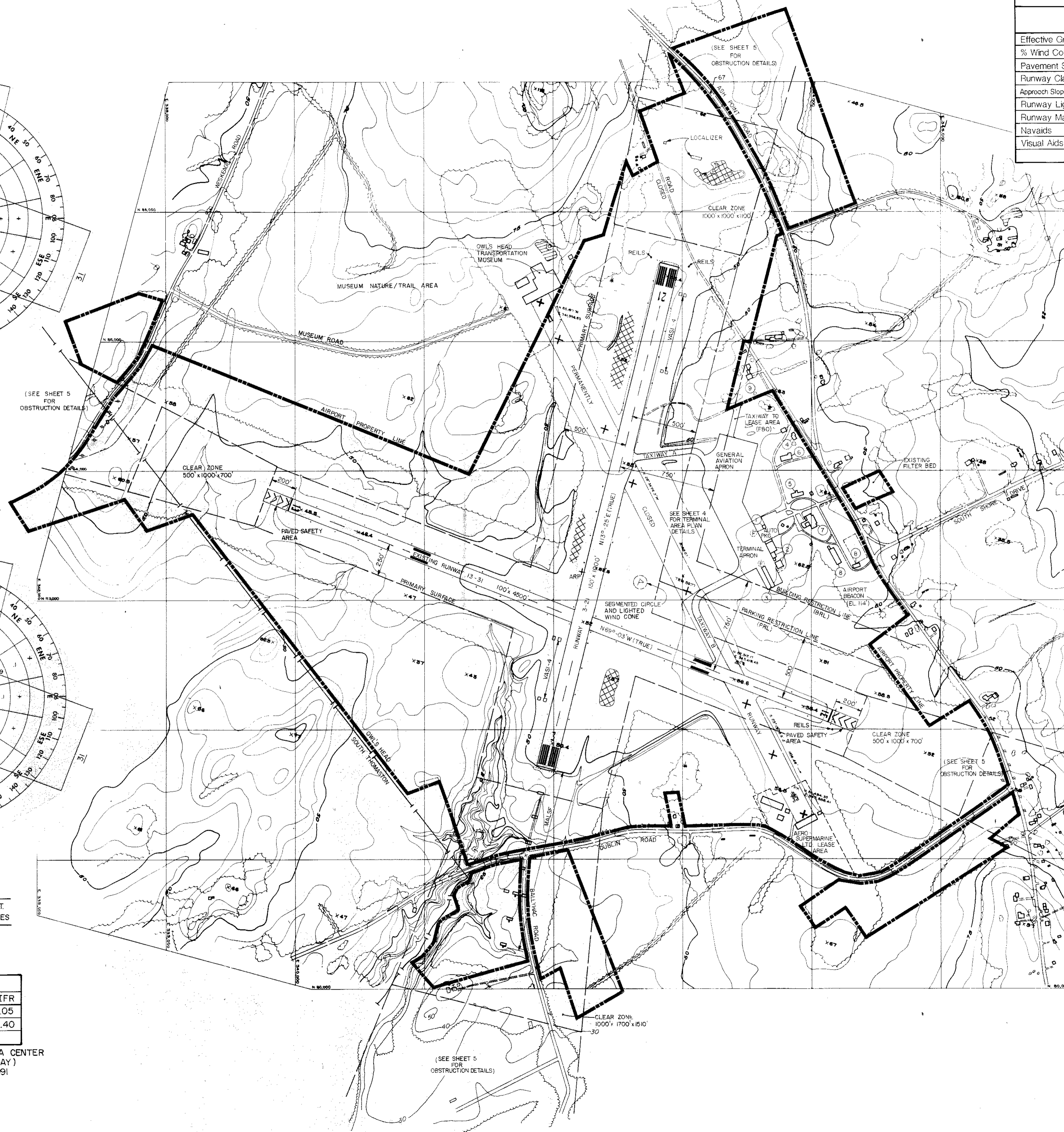



Element	Date
Runway 3/21 safety areas of 200' x 300'	
Runway 13/31 safety areas of 200' x 300'	
Utility standard offset for parallel taxiway to R/W 13/31 (25C)	

	RUNWAY 3-21		RUNWAY 13-31	
	EXISTING	ULTIMATE	EXISTING	ULTIMATE
Effective Gradient (%)	0.13	SAME	0.24	SAME
% Wind Cover (12 MPH)	94.2	SAME	93.9	SAME
Pavement Strength	NON-PREC.	SAME	V15AL	SAME
Runway Classification	1-130,000 0-44,000	SAME	1-130,000 0-44,000	SAME
Approach Slope (Part 77/TERPS)	R/W 3-21: 1/20.1 R/W 21-23: 1/20.1	SAME	20:1	SAME
Runway Lighting	MIRL	MIRL	MIRL	SAME
Runway Marking	NON-PREC.	SAME	BASIC	SAME
Nav aids	LDC, MALS/F	LDC/UME, MALS/F	NONE	SAME
Visual Aids	VASI, REILS	SAME	REILS(RW 31)	VASI, REILS

AIRPORT DATA		
	EXISTING	ULTIMATE
Airport Elevation (MSL)	558'	615'
Airport Reference Point (ARP)	24° 04' N 69° 06' W	-
Mean Max. Temp. (Hottest Month)	78°F	78°F
Taxiway Lighting	MITLS	MITLS
Airport Classification	TRANSPORT	TRANSPORT
Airport Property (Acres)	351	354 *

\* Assumes Purchase of Land for MALS/F, Easement Optional

BUILDING DATA		
NO.	STRUCTURE(S)	ELEV.
1	Pilots Lounge/Terminal Building *	69
2	FBO (Downeast) Lease Area - Hangar	89
3	T-Hangar (6 Bay) *	70
4	Airport Manager House	81
5	Storage Building *	70
6	Airport Maintenance Building *	72
7	Non-Aviation (USGS) Building (Storage) *	75
8	Non-Aviation Use Buildings (Storage) *	82
9	FBO Area (Stonington Flying)	80
* Denotes Buildings to be Removed		
10	Proposed Terminal/Maintenance Building	80
11	Proposed 6 Bay T-Hangar	74
12	Proposed 8 Bay T-Hangar	74

LEGEND		
	EXISTING	ULTIMATE
Town Line	---	---
Property Line	---	---
Restriction Lines	---	---
Apron, T/W, R/W	---	---
Buildings	□	□
Fence	---	---
Runway Lights	•	•
Approach Lights	□	□
Fuel Farm	⊙	⊙
Contours	~	~
Clear Zone	---	---
Tree Line	~	~
Utility Poles	⊙	⊙
Commercial Lease Areas	---	---
Ledge Area	XXXX	XXXX

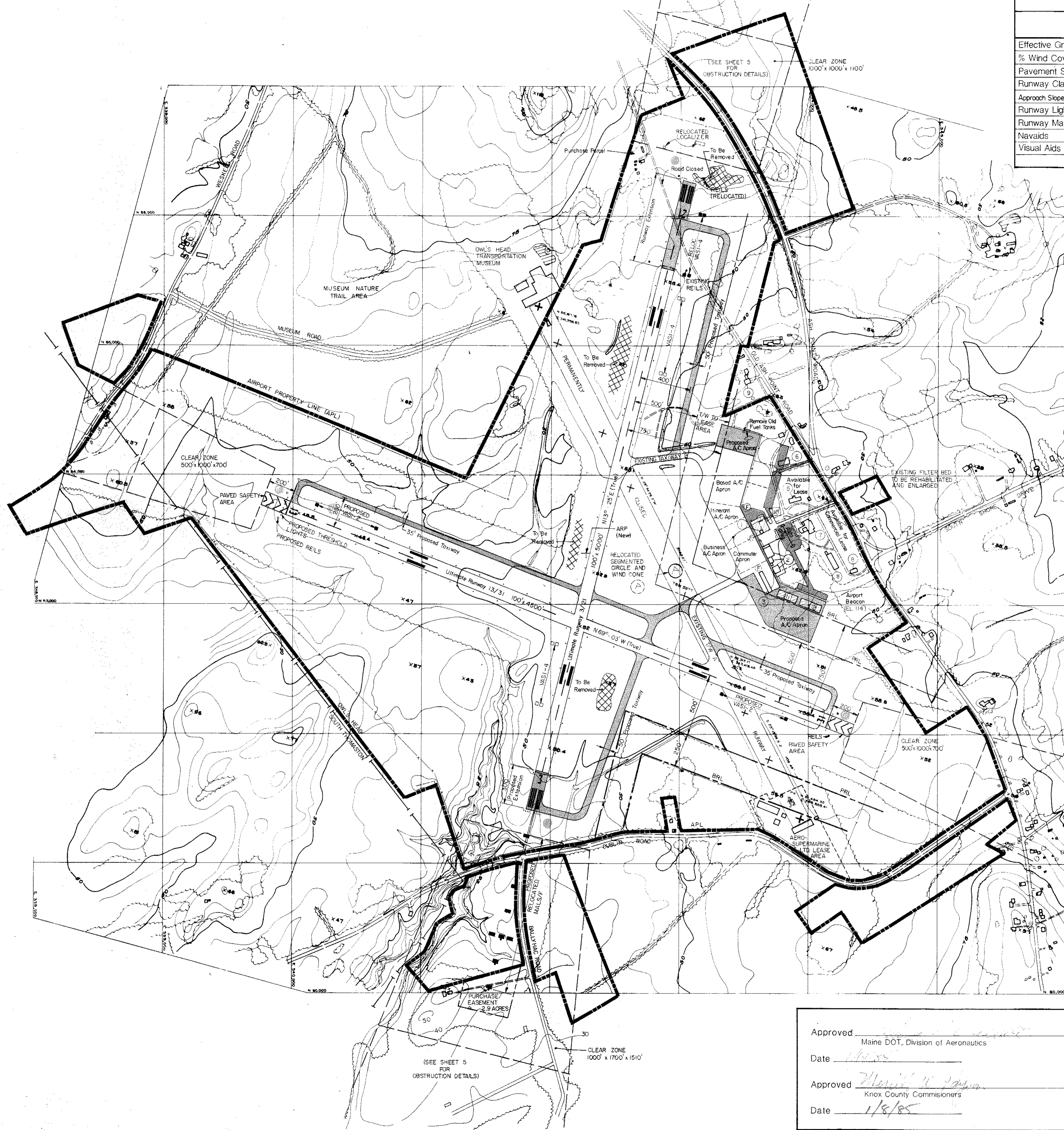

# Knox County Regional Airport MASTER PLAN

## Airport Layout Plan

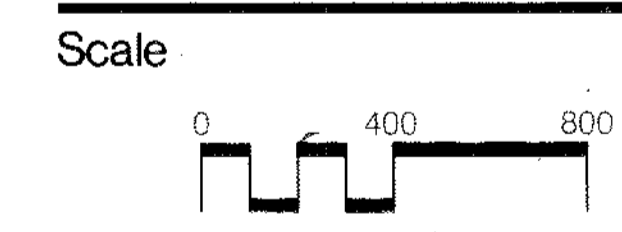

Prepared by  
**Edwards and Kelcey, Inc.**

Date  
September 30, 1984

Approved by

Planner

FEB 5 1985

Dwg. No.  
**3**

Approved \_\_\_\_\_ Director  
Maine DOT, Division of Aeronautics  
Date \_\_\_\_\_

Approved \_\_\_\_\_ Chairman  
Knox County Commissioners  
Date \_\_\_\_\_

U. S. Department of Transportation  
FEDERAL AVIATION ADMINISTRATION  
NEW ENGLAND REGION

Approved: \_\_\_\_\_  
Chief, Planning Branch  
APPROVAL SUBJECT TO COMMENTS  
AND RECOMMENDATIONS IN LETTER

Dated: **MAR 11 1985**



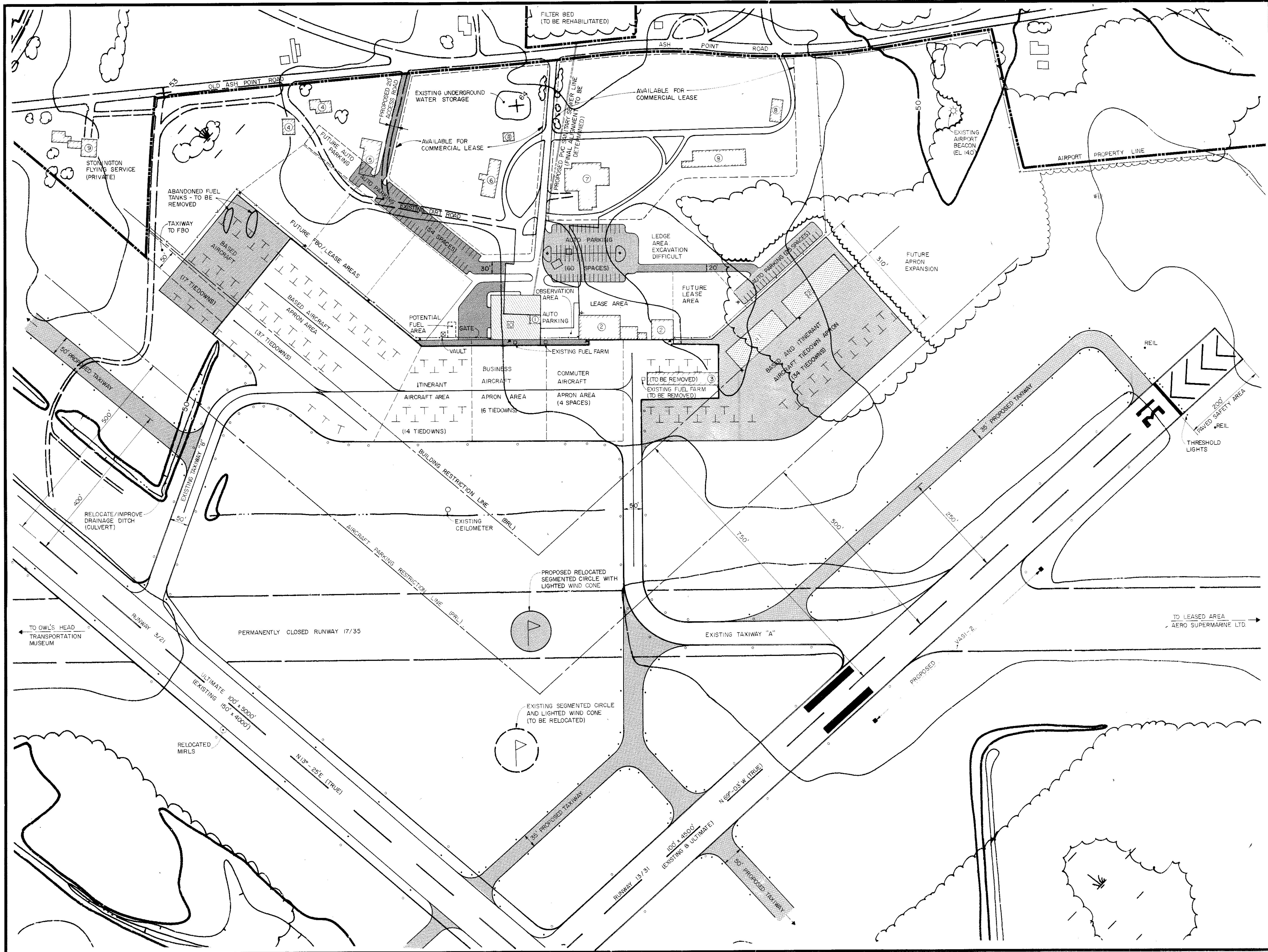

**LEGEND**

---	Airport Property Line
- - - -	Commercial Lease Area
====	Existing Paved Areas
----	Proposed Paved Areas
▭	Existing Structures
▭	Proposed Structures
---	Proposed Sewer Line
---	Proposed Security Fence
⊥	Aircraft Tiedowns
⊥	Proposed Security Lights
⊥	Proposed Roadway Lighting
⊙	Airport Lighting (Exist., Proposed)
---	Restriction Line
~~~~	Existing Tree Line
~~~~	Proposed Tree Line

NO.	STRUCTURE	ELEV.
1	Terminal/Lounge *	69
2	Downeast Leased Hangar	89
3	T-Hangar (6 Bay) *	70
4	Airport Manager	81
5	Storage Building *	70
6	Airport Maintenance Bldg. *	72
7	USGS/Storage Building *	75
8	Non-Aviation Storage Bldgs. *	82
9	FBO Area	80
* Denotes Bldg. to be Removed		
10	Terminal/Maint. Building	80
11	Proposed 6 Bay T-Hangar	74
12	Proposed 8 Bay T-Hangar	74

**Revisions**

Remarks	Date

**Knox County Regional Airport MASTER PLAN**

**Terminal Area Plan**

Scale

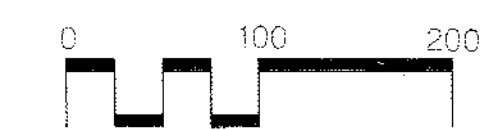

Prepared by

Edwards and Kelcey, Inc.

Date

September 30, 1984

Approved by

Planner

1:25 0 100'

Dwg. No. **4**

MAG. DEC. 18°-30'







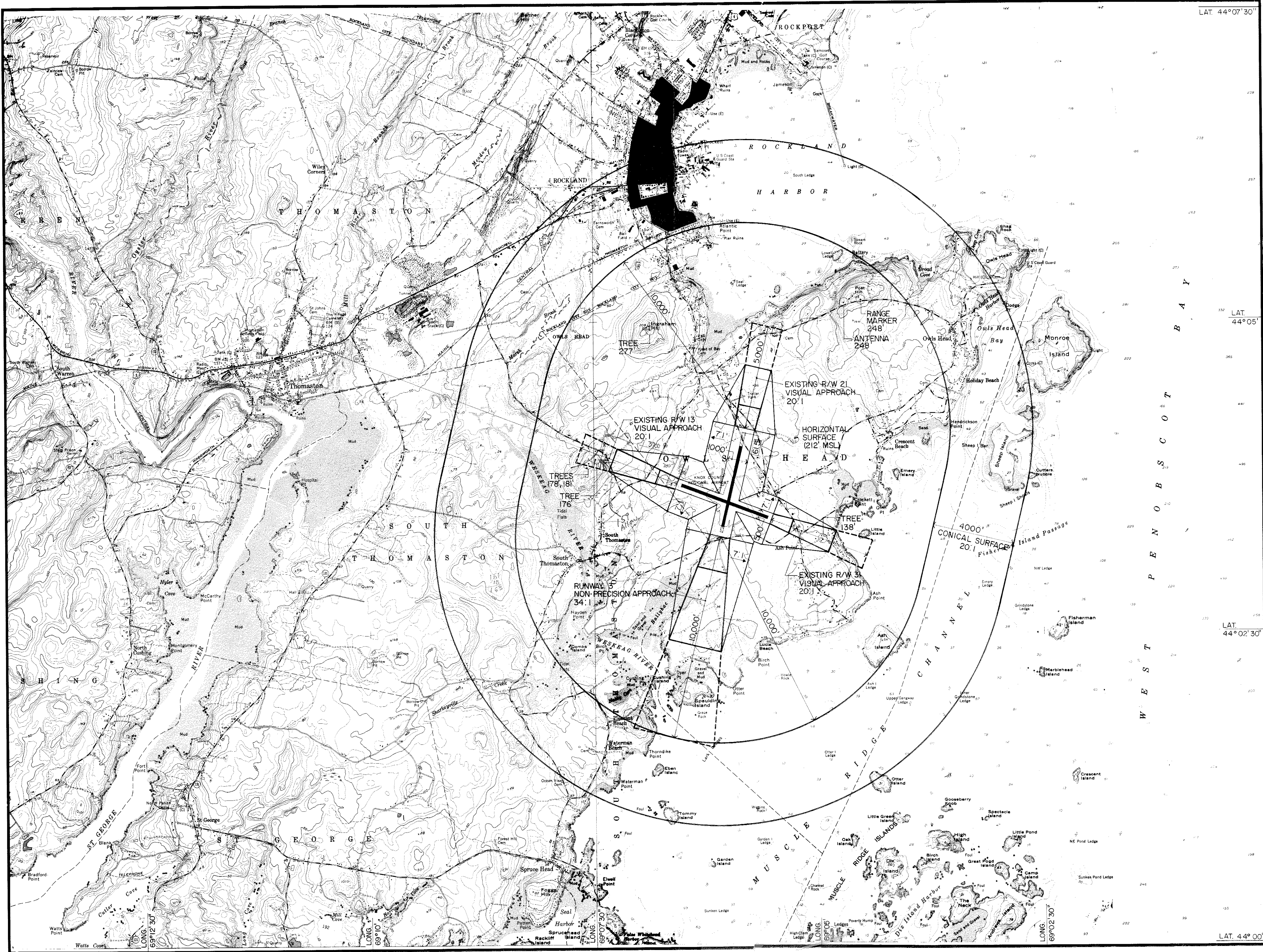

LAT. 44°07'30"

LAT. 44°05'

LAT. 44°02'30"

LAT. 44°00'

Revisions

Remarks	Date

- Legend**
- RUNWAY CLEAR ZONE
  - OBSTRUCTION (DOES NOT PENETRATE FAR 77 SURFACES)
  - HIGHEST RUNWAY END

# Knox County Regional Airport MASTER PLAN

## FAR Part 77 Surfaces

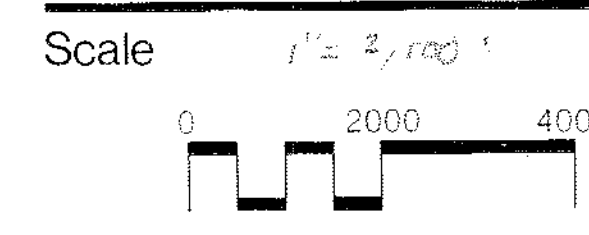

Prepared by  
 Edwards and Kelcey, Inc.

Date  
 September 30, 1984

Approved by

Planner

FEB 5 1985

	Dwg. No.
	<b>6</b>

MAG DEC. 18°-30'



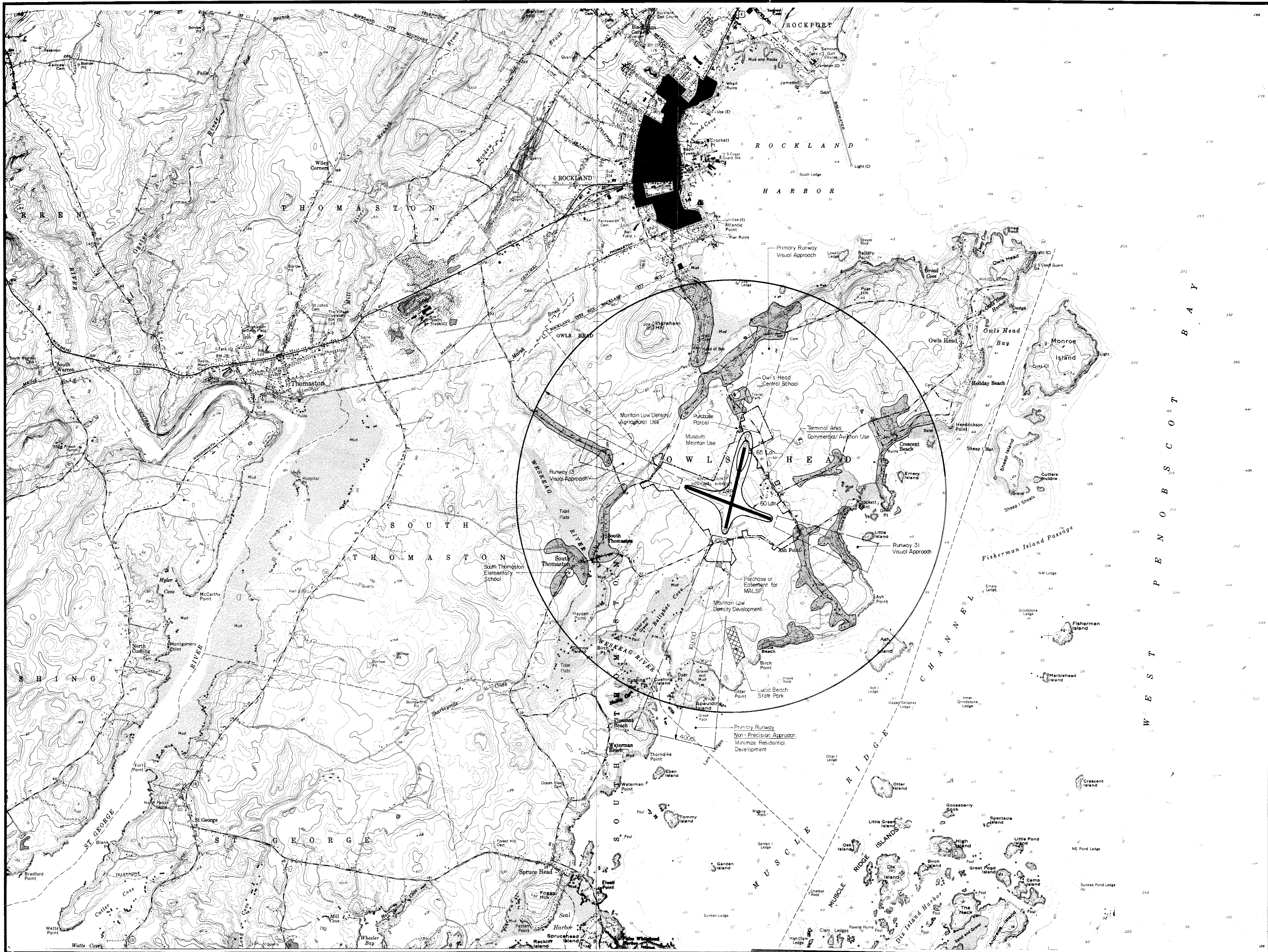

**LEGEND**

	Airport Boundary
	Noise Contours (Ldn)
	Proposed Land Purchase
	Runway Extensions
	Residential Areas
	Parkland
	ARP
	Airport Reference Point

**Revisions**

Remarks	Date

**Knox County  
Regional  
Airport  
MASTER PLAN**

**Land Use Plan  
and Noise  
Exposure  
Contours (Ldn)**

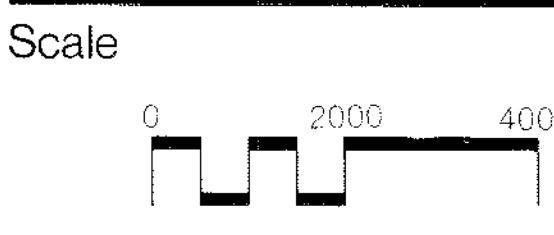

Prepared by  
**Edwards and Kelcey, Inc.**

Date  
September 30, 1984

Approved by

Planner

W.E.D. 1985

Dwg. No. **7**

1/4" = 1" (1:48,000)